

# Sigtronics Y-ADP-TI Adapter Installation Instructions

## Description

Sigtronics Y-ADP-TI adapters are designed to simplify the process of connecting a Sigtronics intercom system to a radio.

## Installation

1. To select an appropriate mounting location for the adapter, first connect it up to the radio.
2. Unplug the hand mic from the radio, you may also have to unhook the cable strain relief, and plug it into jack on the Y-ADP-TI adapter module.
3. Plug the cord connector of the Sigtronics Y-ADP-TI adapter into the hand mic connector on radio.
4. Now you are ready to select a mounting location for the adapter. Select a spot out of the way so that the adapter and its cables will not interfere with the normal operation of the vehicle and secure with the supplied hardware.

5. Route the cable from the Y-ADP-TI adapter and solder / insulate the four wires to the matching wires of the radio input cable from the intercom or MRIM-2 unit.
6. Hook up the speaker wires (2 violet wires) from the Sigtronics intercom or MRIM-2 unit to the .25 inch stereo plug. Connect one violet wire to the Tip and the other violet wire to the Barrel. Leave the Ring open.

**NOTES:** Adjust the Sigtronics intercom or MRIM-2 units transmit and receive levels per their appropriate installation instructions. Your existing radio hand mic and speaker will still function as normal.

**WARRANTY:** One year parts and labor.

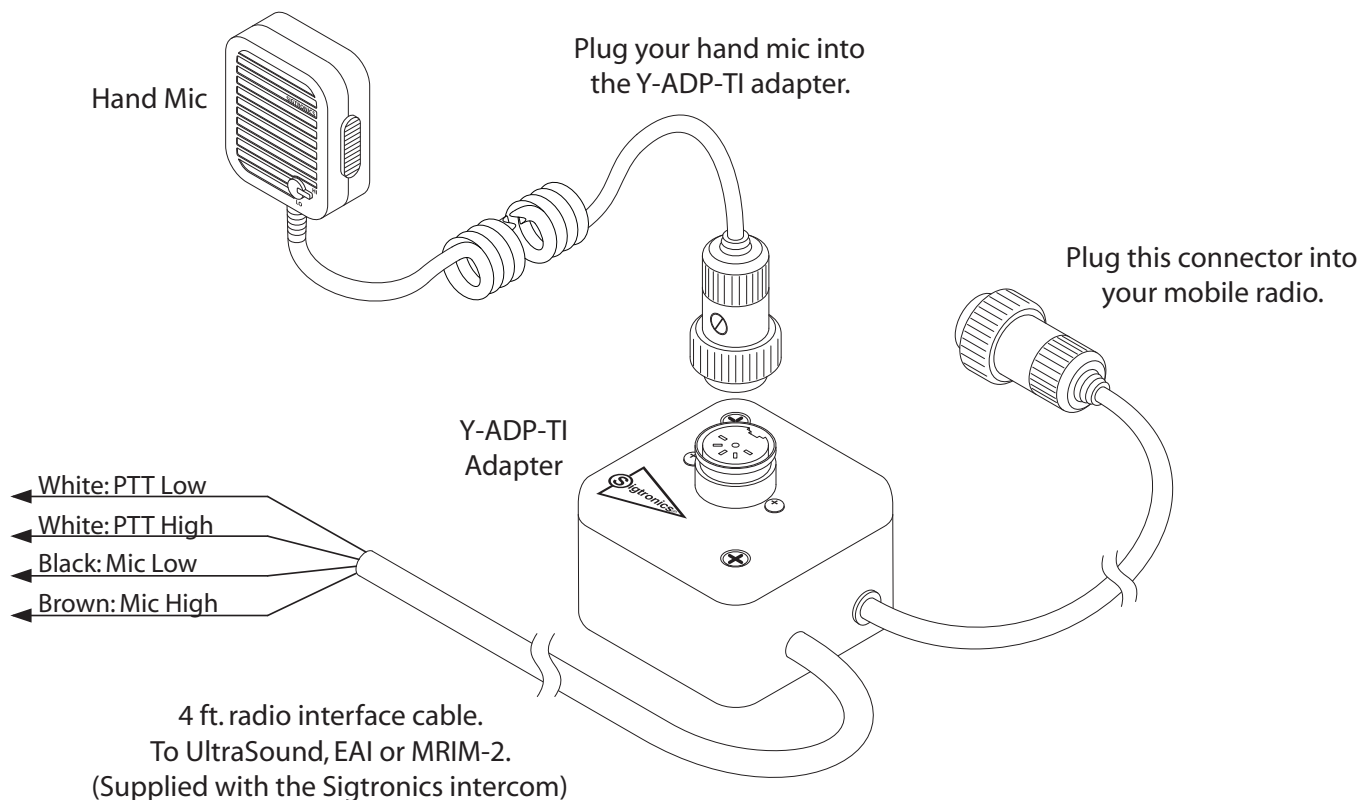

**Specialists in "SOUND" Management**

178 East Arrow Highway, San Dimas, CA 91773 ( 909 ) 305-9399