

The headset is equipped with a stereo / monaural switch on the non-mic side ear cup. For monaural sound or aircraft with only monaural jacks, move the switch to the monaural position. In aircraft equipped for stereo audio, move the switch to the stereo position.

The headset parts may be cleaned with mild soap and water using a soft cloth. Then dry immediately. **Caution: Do Not immerse** any part of the headset in water or any other liquid. Be especially careful not to allow the microphone to become wet! Exposure to moisture may cause internal corrosion and failure and will void your manufacturers warranty.

Cleaning will help the headset maintain its "like new" condition for many years.

WINDSCREEN

The microphone windscreen will reduce annoying wind noise and breath pops picked up by headset microphones. It also protects the microphone element from dirt and moisture. The windscreen should be washed regularly to maintain hygiene and avoid clogging. Wash in warm water and mild soap. Rinse thoroughly and make sure it is completely dry before putting it back on.

To remove the windscreen, carefully grasp the windscreen lightly along its entire length and remove from the microphone element being careful not to twist the element itself.

Put the windscreen on the microphone by gently pulling from the open end. Do not pull it so tightly that it stretches against the end of the microphone.

WARRANTY

Your headset is covered by a limited five-year parts and labor warranty. Please see the enclosed warranty card for details.

You may refer to the parts list on the reverse side, if you choose to replace parts yourself. The parts list describes parts for this particular headset only. Parts lists for other models are available on our Web Site or can be obtained by contacting Sigtronics Corporation.



Sigtronics Corporation
178 East Arrow Highway
San Dimas, CA 91773
Phone: 909 305-9399
E-mail: info@sigtronics.com
Web Site: www.sigtronics.com

Model S-68S Headset Instructions

The S-68S series headsets are adjusted at the factory for immediate use with all current standard radio systems in general aviation aircraft. Headsets equipped with two plugs are the standard configuration. The headphone plug is the larger diameter plug and should be inserted into the headphone jack (.250" standard monaural jack). The mic plug is the smaller diameter plug and should be inserted into the microphone jack (.206" standard microphone jack).

The headband is adjustable through a full range of motion, or the locking nuts may be tightened to allow you to custom fit the headset. Place the headset over your head, adjust the slides up until minimum pressure is felt on the top of your head. The headset is now properly adjusted. For maximum noise attenuation, the clamping pressure has been set at the factory. Releasing the clamping pressure by bending the headband is not advised, because loss of attenuation will result. **Note:** If especially small (children) or large headbands are needed, they may be ordered from Sigtronics.

The microphone boom is fully adjustable and will rotate 180 degrees for use on the left or right side of the head. **Make sure you are speaking into the side of the mic labeled "Talk" or substantial loss of gain will occur. Microphone placement should be at the corner of the mouth, approximately 1/4" from the lips.**

When you first connect the headset, turn the volume controls on the headset to maximum (full clockwise on mic side, counterclockwise on pot side), then adjust the listening volume with the audio control of either your radio or intercom as appropriate. Passengers should also turn their individual headset volumes up fully. Doing this allows for a full range of adjustment for each passenger, since those with the most acute hearing can turn their headset volume down, if necessary.

continued on back...



...when it counts!

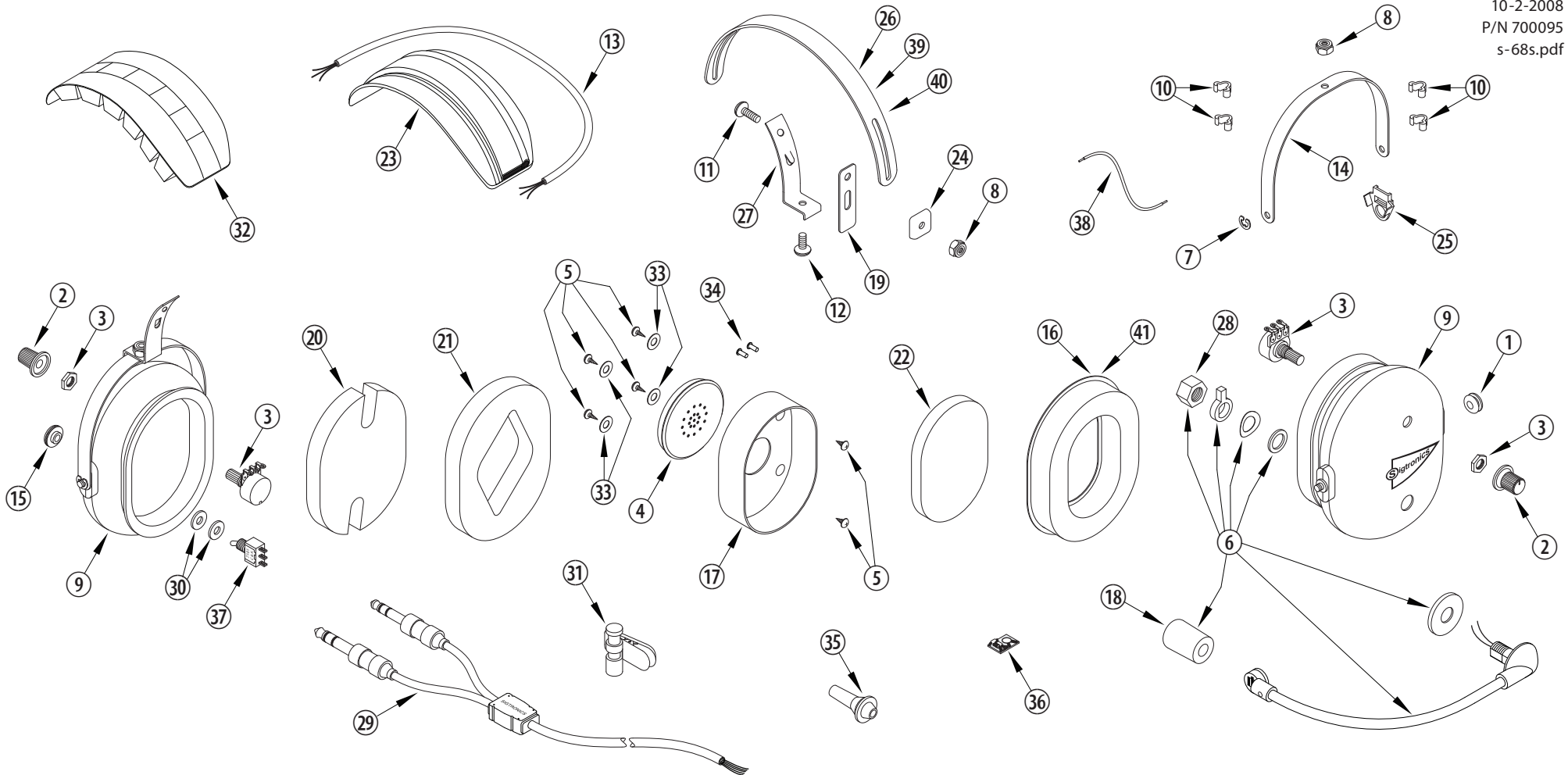

SIGTRONICS S-68S HEADSET PARTS IDENTIFICATION BREAKDOWN

ITEM	P/N	DESCRIPTION	ITEM	P/N	DESCRIPTION	ITEM	P/N	DESCRIPTION
1	100049	GROMMET, 5/16 INCH, RUBBER	15	100530	NUT, STEREO / MONO SWITCH, GOLD	29	800012	CABLE, HEADSET, STEREO
2	100360	KNOB, BLACK, VOLUME	16	100402	EAR SEAL, GEL FILLED	30	100508	WASHER
3	100365	POTENTIOMETER, 2K	17	100423	RECEIVER MOUNT, HEADSET, STEREO	31	100579	CLIP, CLOTHING, HEADSET CABLE
4	100083	RECEIVER, 300 OHM, STEREO	18	900111	WINDSCREEN, MIC, 8 SERIES	32	100610	CUSHION, HEADBAND, FOAM FILLED
5	100108	SCREW, 4-40 X 1/4, THREAD FORMING	19	100373	SLIDE, YOKE BRACKET, LONG, NYLON	33	100135	WASHER
6	800193	MICROPHONE & FLEX BOOM ASSEMBLY	20	100374	FOAM, SOUND ATTENUATING. NOTCHED, 1/2 INCH	34	100130	TERMINAL, SOLDER
7	100520	E-RING, EAR CUP TO YOKE RETAINER, GOLD	21	100376	FOAM, SOUND ATTENUATING. RECEIVER HOLE, 1/2 INCH	35	100569	STRAIN RELIEF, CABLE
8	100524	NUT, HEX, 8-32, LOCKING, GOLD	22	100379	FOAM, SOUND ATTENUATING, RECEIVER COVER, 1/4 INCH	36	800192	PREAMP
9	100616	EAR CUP, PRINTED AND DRILLED, MIC & NON MIC SIDE	23	100606	HEAD BAND EXTRUSION, 6.25 IN., S-68	37	100509	SWITCH, STEREO / MONO
10	100362	CLIP, CROSS-OVER, WIRE, PLASTIC	24	100258	CLIP, HEADBAND GUIDE, PLASTIC	38	100221	WIRE, JUMPER, #22, 4 INCHES
11	100522	SCREW, 8-32 X 1/2, PHILLIPS HEAD, GOLD	25	100393	CLIP, ANTI-ROTATION, YOKE, PLASTIC	39	100674	OPTIONAL - HEADBAND, METAL, GOLD, LARGE
12	100521	SCREW, 8-32 X 3/8, PHILLIPS HEAD, GOLD	26	100514	HEADBAND, METAL, GOLD, STANDARD	40	100673	OPTIONAL - HEADBAND, METAL, GOLD, YOUTH
13	100162	WIRE, 3 CONDUCTOR, #24, BLACK, 28.5 INCHES	27	100516	BRACKET, YOKE SUPPORT WITH TANG, GOLD	41	100369	OPTIONAL - EAR SEAL, FOAM FILLED
14	100515	YOKE, EAR CUP MOUNT, METAL, GOLD	28	100597	NUT, HEX, 3/8-24, FLEX BOOM ADAPTER			