

The headset parts may be cleaned with mild soap and water using a soft cloth. Then dry immediately. **Caution: Do Not immerse** any part of the headset in water or any other liquid. Be especially careful not to allow the microphone to become wet! Exposure to moisture may cause internal corrosion and failure and will void your manufacturers warranty.

Cleaning will help the headset maintain its "like new" condition for many years.

WINDSCREEN

The microphone windscreen will reduce annoying wind noise and breath pops picked up by headset microphones. It also protects the microphone element from dirt and moisture. The windscreen should be washed regularly to maintain hygiene and avoid clogging. Wash in warm water and mild soap. Rinse thoroughly and make sure it is completely dry before putting it back on.

To remove the windscreen, carefully grasp the windscreen lightly along its entire length and remove from the microphone element being careful not to twist the element itself.

Put the windscreen on the microphone by gently pulling from the open end. Do not pull it so tightly that it stretches against the end of the microphone.

WARRANTY

Your headset is covered by a limited five-year parts and labor warranty. Please see the enclosed warranty card for details.

You may refer to the parts list on the reverse side, if you choose to replace parts yourself. The parts list describes parts for this particular headset only. Parts lists for other models are available on our Web Site or can be obtained by contacting Sigtronics Corporation.

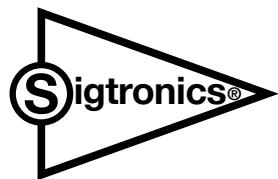

Sigtronics Corporation
178 East Arrow Highway
San Dimas, CA 91773
Phone: 909 305-9399
E-mail: info@sigtronics.com
Web Site: www.sigtronics.com

Model S-58 Headset Instructions

The S-58 series headsets are adjusted at the factory for immediate use with all current standard radio systems in general aviation aircraft. Headsets equipped with two plugs are the standard configuration. The headphone plug is the larger diameter plug and should be inserted into the headphone jack (.250" standard monaural jack). The mic plug is the smaller diameter plug and should be inserted into the microphone jack (.206" standard microphone jack).

The headband is adjustable through a full range of motion, or the locking nuts may be tightened to allow you to custom fit the headset. Place the headset over your head, adjust the slides up until minimum pressure is felt on the top of your head. The headset is now properly adjusted. For maximum noise attenuation, the clamping pressure has been set at the factory. Releasing the clamping pressure by bending the headband is not advised, because loss of attenuation will result. **Note:** If especially small (children) or large headbands are needed, they may be ordered from Sigtronics.

The microphone boom is fully adjustable and will rotate 180 degrees for use on the left or right side of the head. **Make sure you are speaking into the side of the mic labeled "Talk" or substantial loss of gain will occur. Microphone placement should be at the corner of the mouth, approximately 1/4" from the lips.**

When you first connect the headset, turn the volume control on the headset up to the full clockwise position, then adjust the listening volume with the audio control of either your radio or intercom as appropriate. Passengers should also turn their individual headset volumes up fully. Doing this allows for a full range of adjustment for each passenger, since those with the most acute hearing can turn their headset volume down, if necessary.

continued on back...

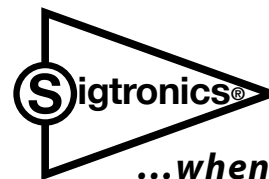

...when it counts!

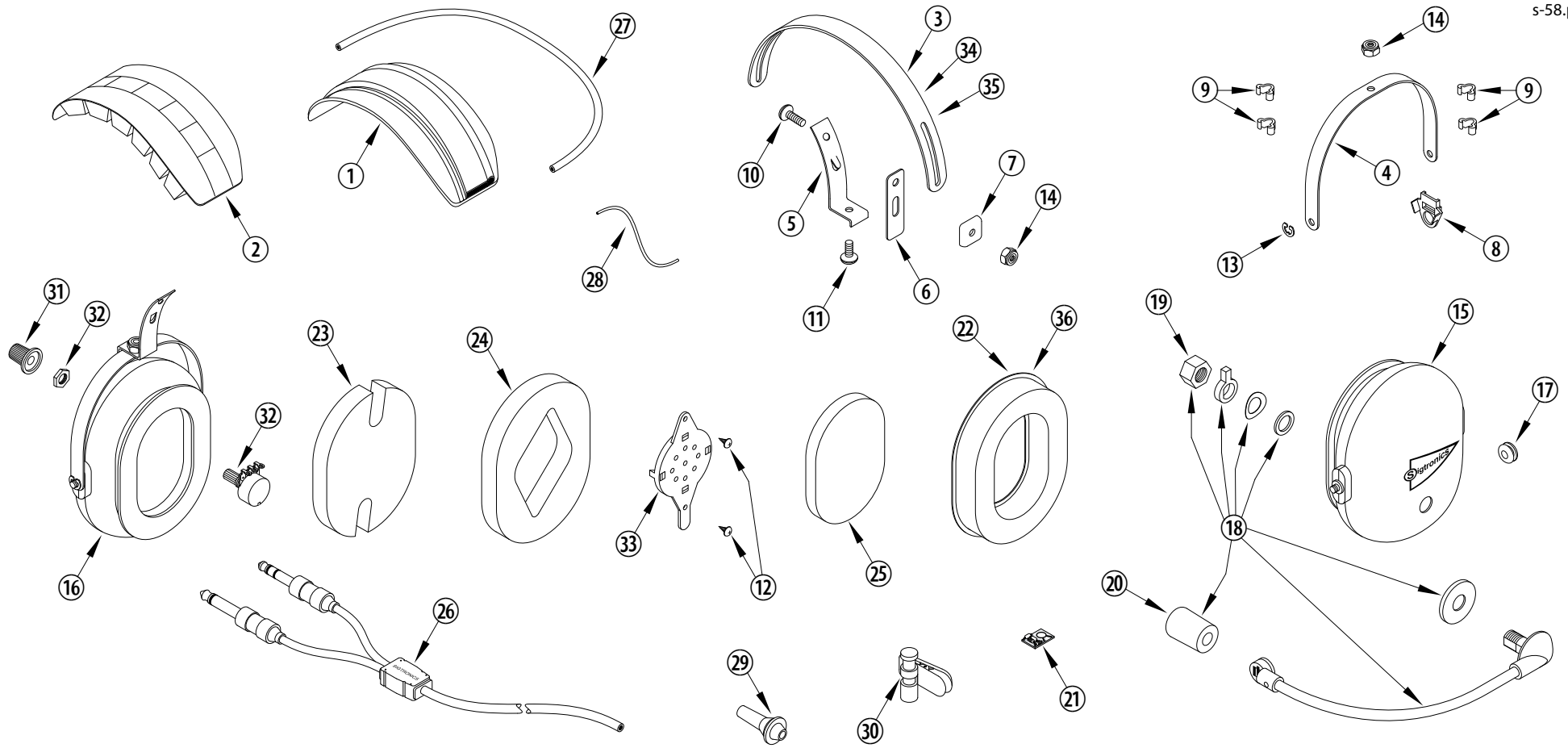

SIGTRONICS S-58 HEADSET PARTS IDENTIFICATION BREAKDOWN

ITEM	P/N	DESCRIPTION	ITEM	P/N	DESCRIPTION	ITEM	P/N	DESCRIPTION
1	100605	HEAD BAND EXTRUSION, 6.25 IN., S-58	13	100251	E-RING, EAR CUP TO YOKE RETAINER	25	100379	FOAM, SOUND ATTENUATING, RECEIVER COVER, 1/4 INCH
2	100610	CUSHION, HEADBAND, FOAM FILLED	14	100252	NUT, HEX, 8-32, LOCKING	26	800036	CABLE, HEADSET, MONAURAL
3	100602	HEADBAND, METAL, BLACK, STANDARD	15	100941	EAR CUP, PRINTED AND DRILLED, MICROPHONE SIDE	27	100933	WIRE, CROSSOVER, OVER THE HEAD, 28 INCH
4	100603	YOKE, EAR CUP MOUNT, METAL, BLACK	16	100938	EAR CUP, PRINTED AND DRILLED, VOLUME CONTROL SIDE	28	100935	WIRE, #22, JUMPER, HEADSET, 4 INCH
5	100604	BRACKET, YOKE SUPPORT WITH TANG, BLACK	17	100049	GROMMET, 5/16 INCH, RUBBER	29	100569	STRAIN RELIEF, CABLE
6	100373	SLIDE, YOKE BRACKET, LONG, NYLON	18	800044	MICROPHONE & FLEX BOOM ASSEMBLY	30	100579	CLIP, CLOTHING, HEADSET CABLE
7	100258	CLIP, HEADBAND GUIDE, PLASTIC	19	100597	NUT, HEX, 3/8-24, FLEX BOOM ADAPTER	31	100360	KNOB, BLACK, VOLUME
8	100393	CLIP, ANTI-ROTATION, YOKE, PLASTIC	20	900111	WINDSCREEN, MIC, 8 SERIES	32	100365	POTENTIOMETER, 2K
9	100362	CLIP, CROSS-OVER, WIRE, PLASTIC	21	800250	PREAMP	33	100858	RECEIVER AND MOUNT, 300 OHM, MONO
10	100363	SCREW, 8-32 X 1/2, PHILLIPS HEAD	22	900124	EAR SEAL, GEL FILLED, SET OF TWO	34	100672	OPTIONAL - HEADBAND, METAL, BLACK, YOUTH
11	100364	SCREW, 8-32 X 3/8, PHILLIPS HEAD	23	100374	FOAM, SOUND ATTENUATING. NOTCHED, 1/2 INCH	35	100613	OPTIONAL - HEADBAND, METAL, BLACK, LARGE
12	100108	SCREW, 4-40 X 1/4, THREAD FORMING	24	100376	FOAM, SOUND ATTENUATING. RECEIVER HOLE, 1/2 INCH	36	900123	OPTIONAL - EAR SEAL, FOAM FILLED, SET OF TWO