

## WARRANTY

Your hearing protector is covered by a limited one-year parts and labor warranty. Please see the enclosed warranty card for details.

You may refer to the parts list on the reverse side, if you choose to replace parts yourself. The parts list describes parts for this particular hearing protector only. Parts lists for other models are available on our Web Site or can be obtained by contacting Sigtronics Corporation.



Sigtronics Corporation  
178 East Arrow Highway  
San Dimas, CA 91773  
**Phone:** 909 305-9399  
**E-mail:** info@sigtronics.com  
**Web Site:** www.sigtronics.com

## Model SEP-40 Hearing Protector Instructions

The SEP-40 series of hearing protectors are adjusted at the factory for immediate use.

The headband is adjustable through a full range of motion, and the locking nuts may be tightened to allow you to custom fit the hearing protector. Place the hearing protector over your head and adjust the slides up until minimum pressure is felt on the top of your head. For maximum noise attenuation, the clamping pressure of the headband has been set at the factory. Releasing the clamping pressure by bending the headband is ***not advised***, because loss of attenuation will result.

The hearing protector parts may be cleaned with mild soap and water using a soft cloth. Then dry immediately.

Cleaning will help the hearing protector maintain its "like new" condition for many years.

continued on back...



***...when it counts!***

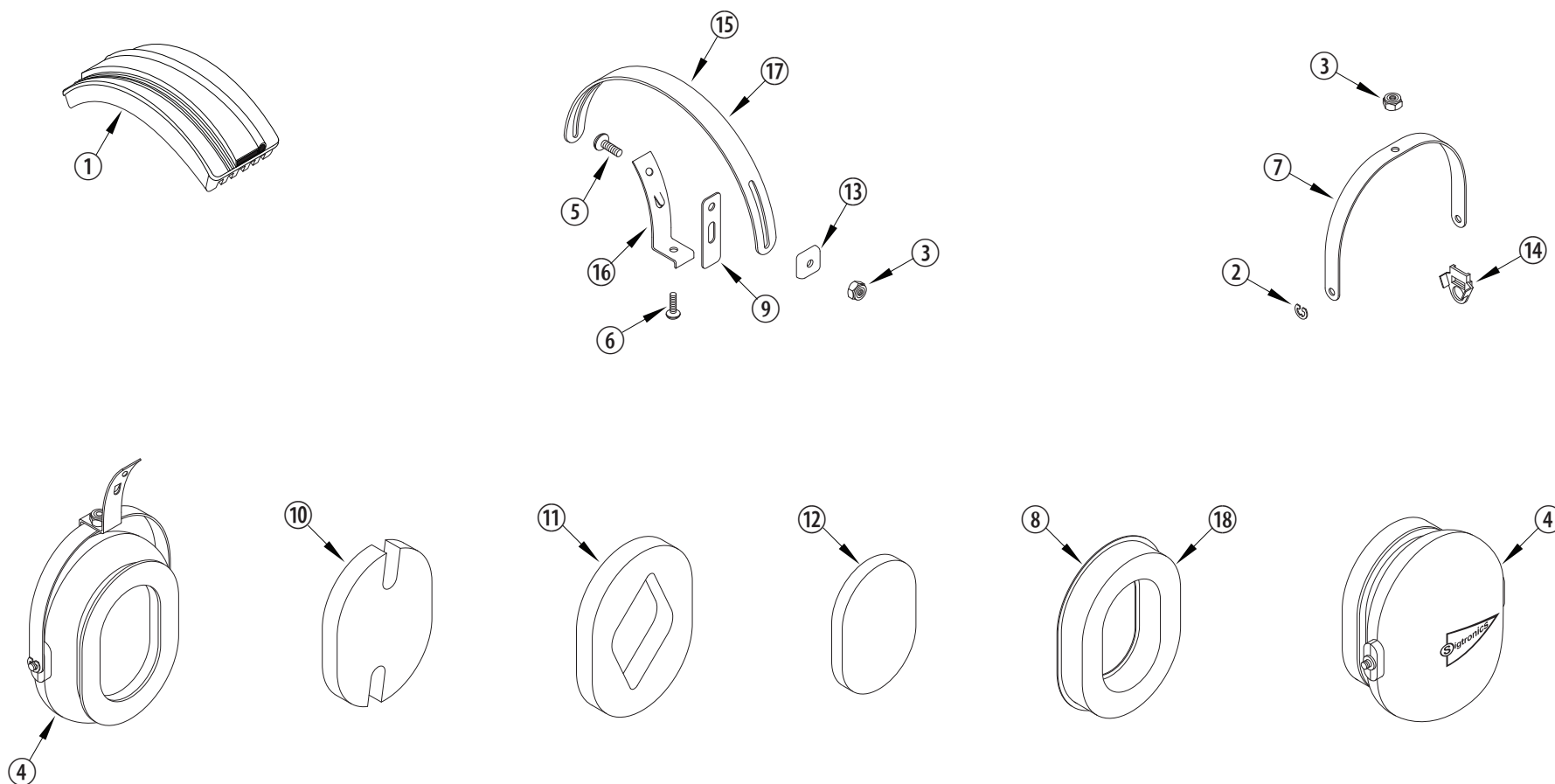

### SIGTRONICS SEP-40 HEARING PROTECTOR PARTS IDENTIFICATION BREAKDOWN

ITEM	P/N	DESCRIPTION	ITEM	P/N	DESCRIPTION	ITEM	P/N	DESCRIPTION
1	800048	HEADBAND , WITH CUSHION, SE-40	7	100367	YOKE, EAR CUP MOUNT, METAL	13	100258	CLIP, HEADBAND GUIDE, PLASTIC
2	100251	E-RING, EAR CUP TO YOKE RETAINER	8	100369	EAR SEAL, FOAM FILLED	14	100393	CLIP, ANTI-ROTATION, YOKE, PLASTIC
3	100252	NUT, HEX, 8-32, LOCKING	9	100373	SLIDE, YOKE BRACKET, LONG, NYLON	15	100383	HEADBAND, METAL, STANDARD
4	100361	EAR CUP, PRINTED AND DRILLED	10	100374	FOAM, SOUND ATTENUATING. NOTCHED, 1/2 INCH	16	100384	BRACKET, YOKE SUPPORT WITH TANG
5	100363	SCREW, 8-32 X 1/2, PHILLIPS HEAD	11	100376	FOAM, SOUND ATTENUATING. RECEIVER HOLE, 1/2 INCH	17	100257	OPTIONAL – HEADBAND, METAL, LARGE
6	100364	SCREW, 8-32 X 3/8, PHILLIPS HEAD	12	100379	FOAM, SOUND ATTENUATING, RECEIVER COVER, 1/4 INCH	18	100402	OPTIONAL – EAR SEAL, GEL FILLED